

## **DEBORAH PERLMAN**

*Statement & Bio*

*Website*

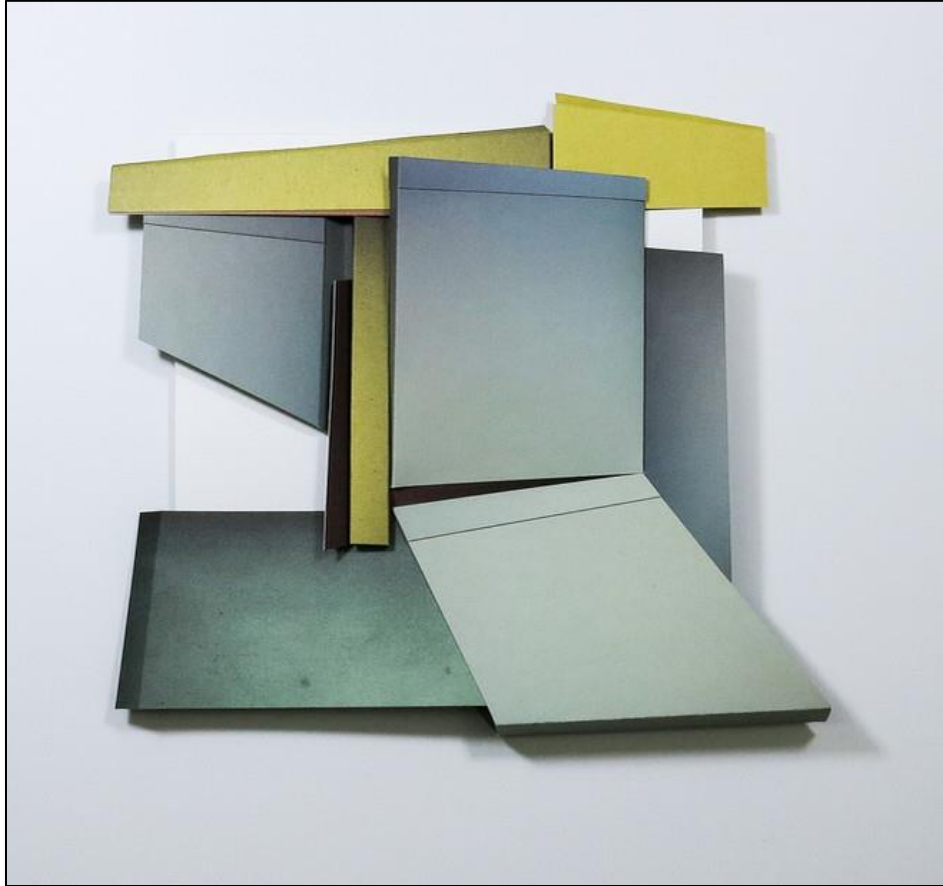

**-Deborah, we'd love to hear your story and how you got to where you are today, both personally and as an artist.**

I was fortunate to have an excellent art education, receiving a BFA degree at Boston University and MFA degree at Cranbrook Academy of Art, both with a concentration in sculpture. After grad school, I decided to pursue a career in the corporate world for two reasons: I wanted to learn more about life outside the art studio, and, on a practical level, I needed to make a living!

But art was never out of reach. I was either using my creative skills in the workplace (presentations, reports, marketing materials, web design, etc.) or in my free time (drawing, collage, and photography). When I could afford it, I left the corporate world and jumped back into making art full time. It has been joyful to reunite with my true spirit as an artist.



**-How do you approach the concept of space in your work, and what kind of effect are you trying to create for the viewer?**

The spaces in my work land somewhere between authentic and imagined, sliding in and out of reality. My goal is to create spaces that challenge the senses, evoke emotion, and ask the viewer to consider: What is it? Where is it? What do they see and feel? And do they find themselves in it – or not?

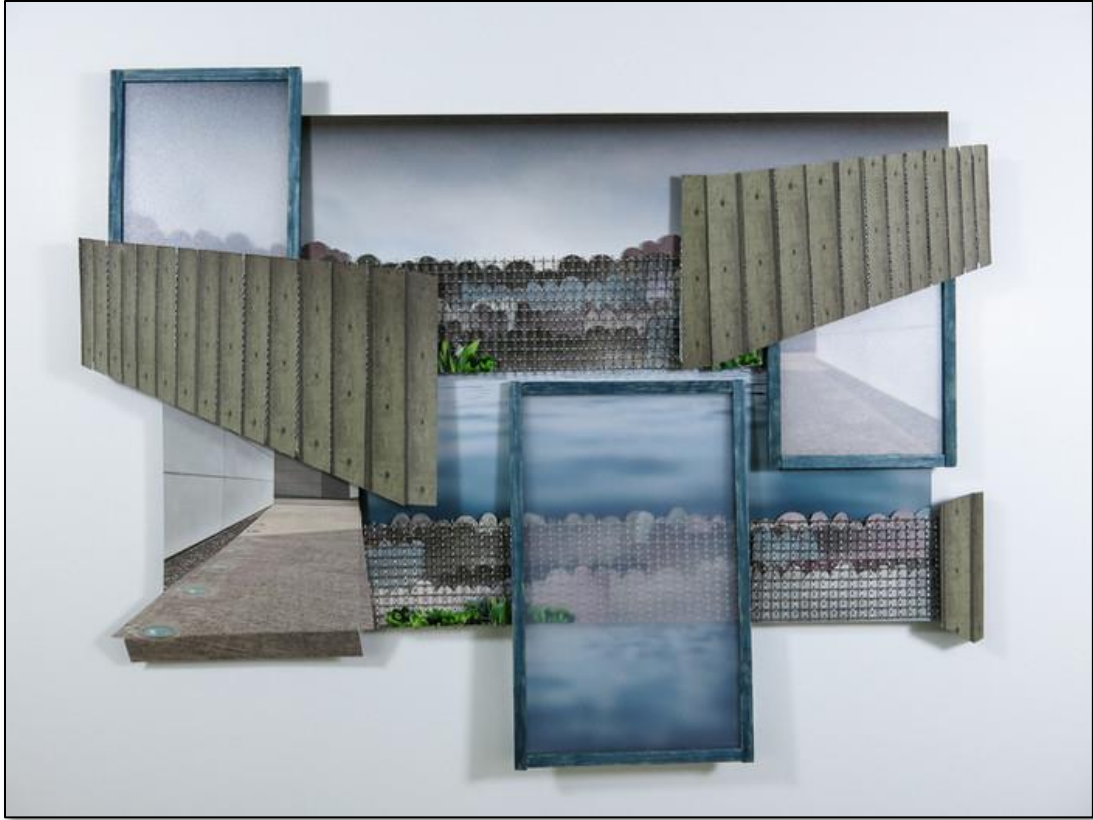



**-Can you talk about how you choose the materials you work with, and how they contribute to the final piece?**

I am a builder! My wall sculptures are made with digitally colored paper, and I have recently added new materials including translucent plastic, different types of wire mesh, aluminum wire, wood and whatever adhesive works with each surface. I just walked through Home Depot and found several new materials I plan to experiment with in new work. I work with materials that help me reinforce the theme of the piece, such as wire mesh to suggest an enclosed, restricted space.

**-What role do shadows play in your work, and how do you use them to enhance the overall effect?**

Shadows are so important in my work. The moment I juxtapose two three-dimensional forms, their shadows reinforce the depth of the space. Shadows make my sculpture 'pop' from the wall. They tell the 'story' of the space.

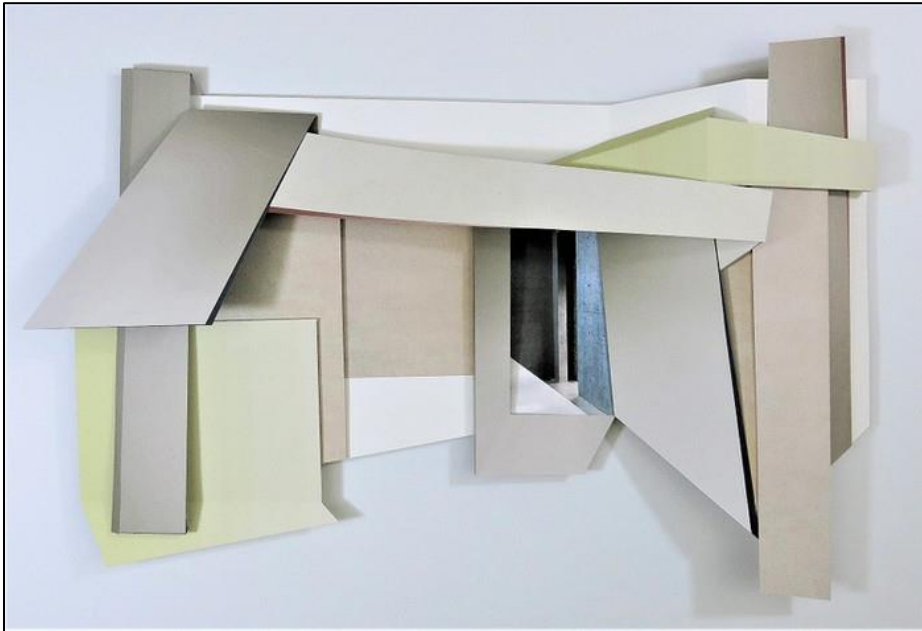

**-What's the best way for someone to check out your work and provide support?**

The best way to keep up with my new work and get a behind-the-scenes look at my creative process is to explore my website at [www.artbydperlman.com](http://www.artbydperlman.com), where you can also sign up for my newsletter. Also, keep up with my latest news, by following me on Instagram [@deborahwperlmanart](https://www.instagram.com/deborahwperlmanart)